

BMM-Kaste blokke
BMM-Snatch blocks
BMM-Pastecas de disparo

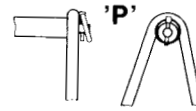
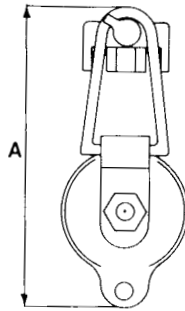
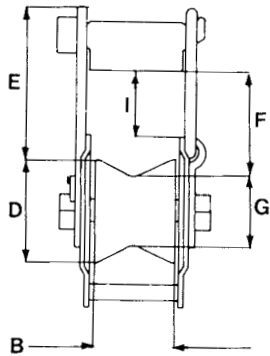

Galvaniseret
 Galvanized
 Galvanizadas

Blok vare nr. Block part no. Pasteca art. no.	SWL 5:1	Max load on head- fitting	Test load	A	B	D	E	F	G	I	Vægt Weight Peso
	Ton	Ton	Ton	mm	mm	mm	mm	mm	mm	mm	Kg
KS 110-□ E	3,0	6,0	12,0	255	85	110	68	85	70	45	10,0
KS 150-□ E	5,0	10,0	20,0	330	85	150	75	85	110	55	19,2
KS 215-□ E	8,0	16,0	32,0	425	100	215	95	100	170	63	39,5

BMM-Blokke skal bestilles med:
 BMM-Bloks must be ordered with:
 Pastecas BMM se pueden pedir con:

- enten either o

1

 Kugleleje, smørbar.
Ball bearing, greaseable.
Rodamiento para engrasar.
- eller or o

0

 Bronzeleje, smørbar.
Bronze bushing, greaseable.
Cojinete de bronce para engrasar.

Mod tillæg kan alle blokke leveres:
 Against extra charge are all blocks available:
 Todas Pastecas estan disponibles, contra suplemento de precio:

- 'C' Testet med certifikat.
Tested with certificate.
Probadas y certificadas.
- 'P' Split ved lukkemekanisme.
Split pin at locking device.
Punzon de seguridad.

Ved bestilling tilføj bogstav, f.eks. KS 150-1EGC.
 On order add letter, e.g. KS 150-1EGC.
 Indicar en su pedido p.e. KS 150-1EGC.